

## WARRANTY

WillowWood warrants each One Sleeve from the date of invoice for a period of ninety (90) days against defects in material and workmanship.

A product returned during the warranty period will be evaluated and repaired or replaced at WillowWood's discretion. To avoid restocking fees, you must obtain a Return Material Authorization (RMA) Number prior to the return of any WillowWood product. Call 740-869-3377 or 800-848-4930 to obtain an RMA.

There is no warranty, expressed or implied, for damage caused by abuse, mishandling or accident. The warranty is void if the fitting and routine care instructions are not followed. For your protection and ours, please thoroughly clean all used products prior to return.

### Warranty Disclaimer

WillowWood warrants that each product manufactured will, at the time of delivery, be of workmanlike quality and substantially free of defects. WILLOWWOOD MAKES NO OTHER WARRANTY, IMPLIED, OR EXPRESSED, AND MAKES NO WARRANTY OF MERCHANTABILITY OR FITNESS FOR A PARTICULAR PURPOSE. This warranty shall terminate immediately upon an action to combine our products with other materials or in any manner to change the nature of our products. The sole remedy is replacement of the products or credit for the products. Willow Wood's liability shall not exceed the purchase price of the product. WillowWood shall not be liable for any indirect, incidental, or consequential damage.

### WillowWood Retention of Rights

WillowWood retains all intellectual property rights reflected or incorporated in its physical products, regardless of the transfer of the physical products to another party or parties.

## TRIMMING THE SLEEVE

The silicone portion at the proximal end of the One Sleeve may be trimmed if necessary. Do not trim the portion of the sleeve that is covered by fabric.



**Caution: Alpha products can melt or burn if exposed to high temperatures or flame. Do not expose your Alpha product to these conditions.**



**Caution: This Alpha product is intended for use on a single patient. Use of the product with multiple patients could lead to cross contamination between patients.**



**Warning: To avoid danger of suffocation, keep this product away from babies or children.**



**Warning: WillowWood One Transtibial System components have been designed and tested for use only with other WillowWood One Transtibial System components. Use with other sealing systems may result in loss of suspension resulting in injury.**

# WillowWood®

The Ohio Willow Wood Company  
15441 Scioto Darby Road  
Mt. Sterling, OH 43143  
phone 740.869.3377 / 800.848.4930  
fax 740.869.4374 www.willowwoodco.com

Ohio Willow Wood Company B.V.  
Keizersgracht 62/64  
1015 CS Amsterdam  
The Netherlands



PN-2510-A 13 MAR 2017

# WillowWood®

## One Sleeve Prosthetist Instructions



### WHAT'S IN THE BOX

One Sleeve  
User Instructions  
Prosthetist Instructions

These instructions are for a replacement One Sleeve ordered for the WillowWood One® Transtibial System. Please refer to the **WillowWood One Transtibial System Prosthetist Instructions** for complete information.

Please provide the amputee with the **User Instructions** included in the box.

## REMOVING EXISTING SLEEVE

1. Fold the large end of the sleeve down onto the socket to expose the open end of the socket.



Have the patient step out of the socket.

Unfold the One Sleeve so that it is not covering the socket.

2. Disassemble the One Link as shown:

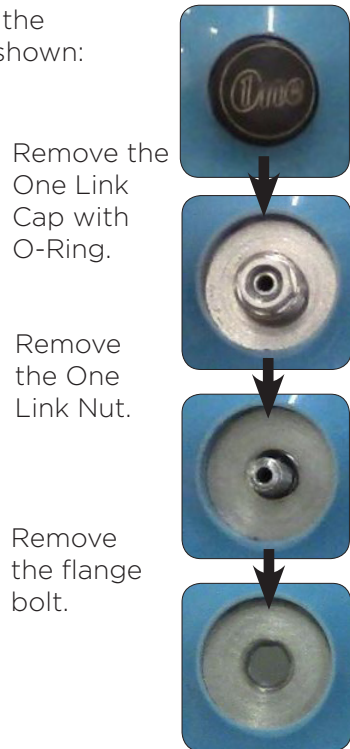

Remove the One Link Cap with O-Ring.

Remove the One Link Nut.

Remove the flange bolt.

3. Separate the flexible socket from the laminated socket.
4. Remove the One Sleeve from the flexible socket.

## DONNING NEW SLEEVE

1. Locate anterior on the One Sleeve.
2. For ease of assembly, mist the outside of the flexible socket and the inside of the sleeve with alcohol.
3. While the flexible socket and sleeve are still damp, slide the sleeve onto the flexible socket:



- The larger end of the sleeve should be toward the top, and the smaller end with the sealing fins should be toward the bottom.
- The distal edge of the sleeve should be about 2" (5 cm) below the posterior trim line of the socket.

4. Insert the flexible socket with the One Sleeve on it into the laminated socket. Align the hole on the flexible socket with the One Link hole on the laminated socket. Lightly mist the One Sleeve fins or the inside of the socket with alcohol if necessary.



5. Insert the flange bolt through the flexible socket and One Link hole. Apply Loctite® Threadlocker Blue 242® (or equivalent) to the flange bolt.



6. Using a 7 mm socket, install the One Link Nut onto the flange bolt. Tighten to 25 in lb.

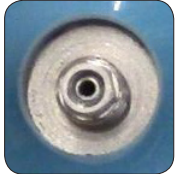

**Do not over-tighten.**

7. Screw on the One Link Cap with O-Ring.



8. Fold the large end of the sleeve down onto the socket to expose the open end of the socket.



9. Have the patient step into the socket and pull the sleeve up onto the residual limb.

